

Installation instruction01

● Preview

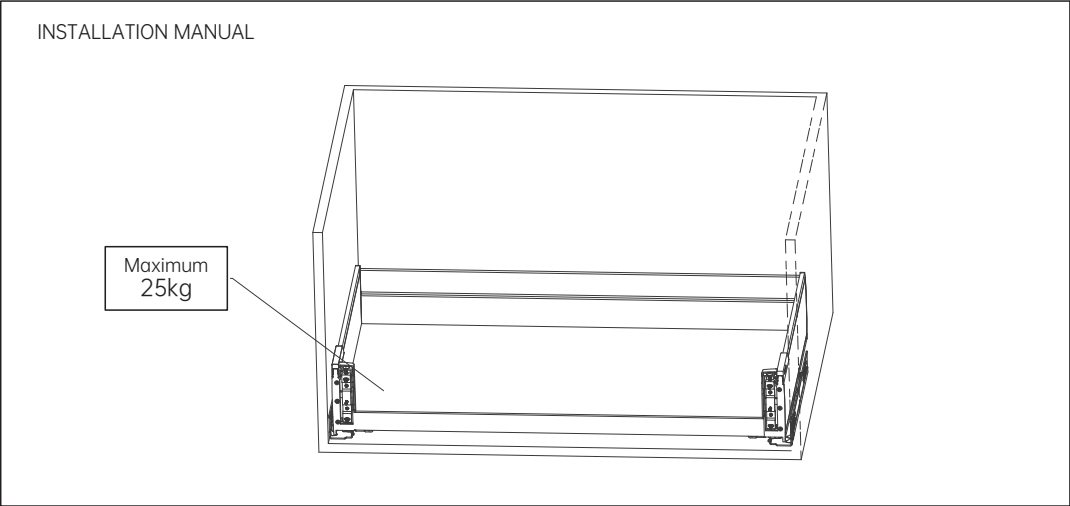

● Accessories List

A	X 1SET	B	X 1PCS	C	X 6PCS	D	X 6PCS	E	X 2PCS
Slide Rail		Basket		Countersunk Self-Tapping Screws		Flat Head Self-Tapping Screws		Flat Head Machine Screws	
F	X 4PCS	G	X 1PCS	H	X 2PCS	I	X 4PCS	J	X 1PCS
Flat Head Machine Screws		Decorative Cover		Door Board Connector		Machine Screws		Door Board Installation Template	
K									X 1PCS
	Slide Installation Template								

● Product Specifications and Applicable Cabinet Width

Specifications (W x D x H) mm	Cabinet width
564x471x162	564-568
664x471x162	664-668
714x471x162	714-718
764x471x162	764-768
864x471x162	864-868

● Installation instructions

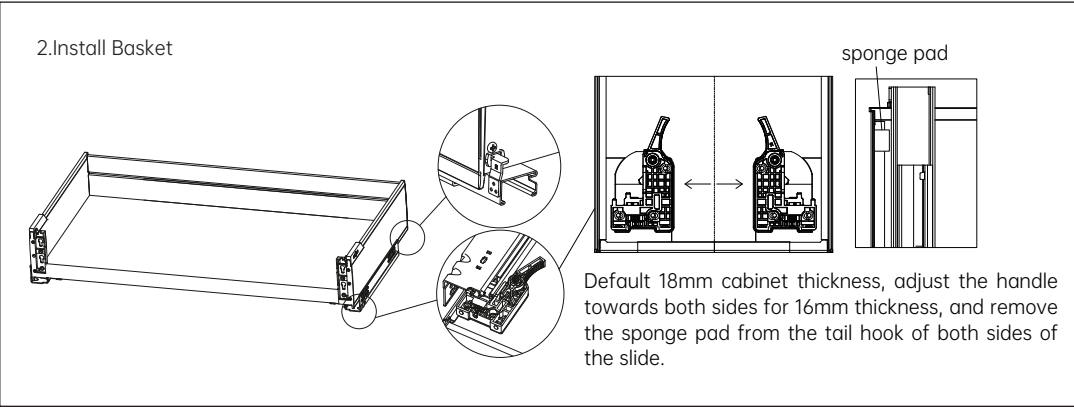
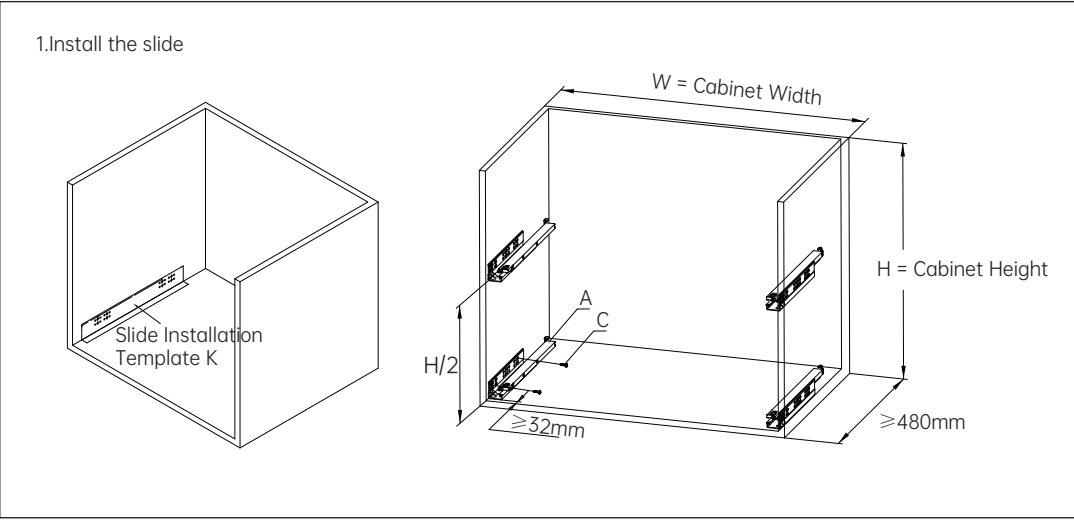

Installation instruction02

3.Install The Door Board

Door Board Installation Size

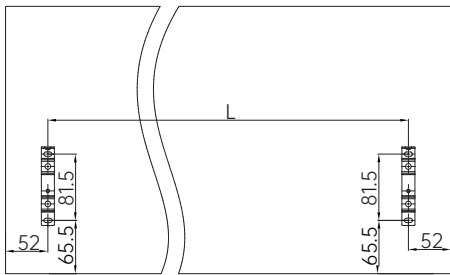
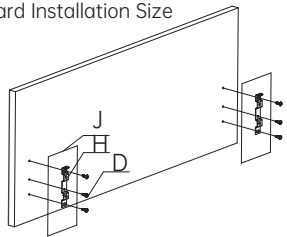

Install H using J.

4.Door Board Installation Screws

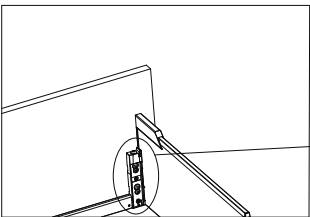

Adjust the door board vertically with E

Adjust the door board horizontally with I;

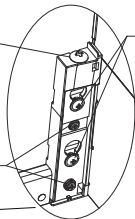

Secure the door board with F

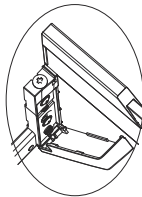

Lock all screws and attach the decorative cover G

5.Flat basket as shown below.

